



**ELKA**  
**INDUSTRIES, INC.**

**QUALITY PLUMBING REPAIR PRODUCTS  
BULK**

**CATALOG ISSUE: JANUARY 2014**

# REPAIR PARTS—BULK





## CATALOG AND ORDER DETAILS

---

### **WARRANTY LIMITATIONS: \***

ELKA Industries Inc. distributes precision replacement parts. Brand names, Model Names, Original Manufacturers' names or Stock Numbers which may appear on invoices, catalogues, packages, quotations or correspondence, are so utilized for purposes of identification only and are not a warranty or representation, either expressed or implied.

\* All manufacturers' names except ELKA INDUSTRIES INC. products used in this catalogue are for reference purposes only and do not indicate original equipment parts.

ELKA Industries Inc. products will fit designated brands and are not to be construed as an endorsement or acknowledgement, either expressed or implied, that products are sold as authentic O.E.M. products made by or licensed by such manufacturers. The original equipment manufacturer bears no liability for the quality of ELKA Industries Inc. products.

This catalogue produced as the JANUARY 2014 issue replaces all previous catalogues, flyers or other notifications.

### **TERMS AND CONDITIONS OF SALE:**

ALL TAXES EXTRA

#### **FREIGHT AND SHIPPING:**

All orders are FOB our warehouse in Pickering, Ontario, Canada.

#### **LEAD TIMES:**

- ELKA Industries Inc. prides itself on delivering orders to customers as soon as possible. All orders placed will be acknowledged with a confirmation and will be shipped out as soon as possible.

#### **PAYMENT TERMS:**

- All orders are payable net 30 days from date of invoice.
- 2% net discount when paid within 15 days or less of the invoice date.
- Any amount past due is subject to a finance charge of 1.5% per month (18% per annum) to the past due balances.

#### **PRICES:**

- Prices are subject to change without notice. All orders will be shipped and invoiced at the prevailing price at the time of shipment. For larger or O.E.M. quantities, we would like the opportunity to quote pricing and scheduled deliveries.

#### **CLAIMS:**

- Claims must be reported within 2 business days of receipt of goods. No claims will be allowed unless reported within said timeframe. All claims for shortages or damages should be reported by consignee, and must be accompanied by a copy of the proof of delivery receipt noting the specific shortage or damage.
- Any claim should be reported to ELKA Industries Inc. Canada offices at 905-839-8888.
- Shipments are made at buyer's risk unless ordered to be insured.
- ELKA Industries Inc. shall not be held responsible in any claim of injury or damage from the installation of ELKA Industries Inc. Merchandise.



## CATALOG AND ORDER DETAILS

---

### RETURNS:

- Returns are not accepted unless we are first notified of reason for the return and have authorized said return via an "RA#" - Return Authorization Number. ELKA Industries Inc. will respond, in most cases, within 24 hours to all RA# requests. An RA# (or reason for decline) will be issued to the customer along with a Return Materials Form (RMF). Returned item(s) must be shipped with the RMF in order to be processed. Failure to include this form will result in the shipment being returned to the customer, at the customer's expense, and credit will not be considered. All RA#s expire 30 days after the date of issue. Returns on product (excluding defective items) will be accepted up to 90 days after date of delivery. Products returned without prior approval will be returned to sender freight collect.
- Return transportation must be PREPAID by customer. Any shipment sent collect will be rejected and returned at the customer's expense. Freight will be credited on defective merchandise or on orders caused by or resulting from shipping errors on our part.
- Credits will be issued at your cost when accompanied by an invoice or PO# otherwise the prevailing price will represent the credited amount.
- Material (excluding defective items) must be received by ELKA Industries Inc. in sellable condition in the original packaging. Material (excluding defective items and our ship errors) will be subject to a minimum 25% restocking charge; Materials not received in original packaging will be subject to an additional 20% repackaging fee. Credits must be taken within one year of receipt.

### MINIMUM ORDER QUANTITIES AND VALUES:

- All orders must be issued in increments of unit order quantities as listed in the catalog. Where only master case quantities are listed, orders must be issued by master case quantities as listed in the catalog. Partial order quantities will be increased to nearest inner case quantities. All orders must be placed conforming to priced units of sale, e.g.: bag, dozen, etc.
- Minimum order value - \$100.00 net

### WARRANTY:

- ELKA Industries Inc.'s warranty shall be limited to replacement of credit, not to exceed the purchase price of the item. Labor and/or installation charges of any kind are not covered by our warranty. The warranty is against defects in workmanship or material for a period of one (1) year from the date of purchase. The warranty covers only the specific use for which each item so designed.
- All claims regarding warranty must be reported to ELKA Industries Inc. within 3 business days of occurrence.

### BACKORDERS:

- If requested by the customer at the time of order, backorders exceeding \$50.00 will be held for 30 days. Backorders under \$50.00 will be cancelled.

### ILLUSTRATIONS/PHOTOGRAPHS:

- All images, photos and drawings in the catalog are intended as general description only. Unless specified, they do not represent any particular brand or likeness.
- Products may not be exactly as shown and may change at any time without prior notification.

### REPRODUCTIONS:

- NO PART of this catalog may be reproduced without the expressed written consent of ELKA Industries Inc. All photography and line art is the property of ELKA Industries Inc. and cannot be reproduced or copied without written permission.

### CATALOG:

- ELKA Industries Inc. shall not be held responsible for typographical errors and will not be held responsible for any liability associated with misprints, errors and/or pricing discrepancies in this publication.



TABLE OF CONTENTS

---

<b><i>BULK REPAIR PARTS</i></b>	<b><i>PAGE</i></b>
TOILET LEVERS.....	5
TOILET FLAPPERS.....	18
WATER CONTROL VALVES.....	21
BOLT CAPS.....	24
INSTALL COMPONENTS.....	25

# REPAIR PARTS—BULK





**ELKA HANDLE STYLE FINISHES AVAILABLE:**

**ELKA “CLASSIC” LEVERS:**

**WHITE**

**CHROME PLATED**

**PVD BRASS PLATED**

**SATIN NICKEL**



**ELKA “ELITE” STYLE LEVERS:**

**WHITE**

**CHROME PLATED**

**PVD BRASS PLATED**

**OIL RUBBED BRONZE**

**SATIN NICKEL**





## ABS TANK LEVERS—ELKA “CLASSIC” HANDLE STYLE

- DURABLE ABS PLASTIC TANK LEVER
- PRE-MOLDED TO SPECIFIC ANGLES AND LENGTHS
- COMPLETE WITH PLASTIC SPUD AND NUT
- REFER TO PAGE 5 FOR AVAILABLE TANK HANDLE FINISHES



SIZE	WHITE	COLOUR (PLEASE SPECIFY)	CHROME PLATED	PVD BRASS PLATED	O R B	SATIN NICKEL
<b>SINGLE SIZE TANK LEVERS:</b>						
<b>5 DEGREE X 4 INCH</b> (FOR USE WITH BEADED CHAIN)	12-930	12-931	12-932	12-928	12-9OR4	12-9SN4
<b>5 DEGREE X 6 INCH</b> (FOR USE WITH BEADED OR HOOK CHAIN)	12-116	12-126	12-136	12-146	12-1OR6	12-1SN6
<b>5 DEGREE X 8 INCH</b> (FOR USE WITH HOOK CHAIN ONLY)	12-940	12-941	12-942	12-938	12-9OR8	12-9SN8
<b>28 DEGREE X 4 INCH</b> (FOR USE WITH BEADED CHAIN ONLY)	12-214	12-224	12-234	12-244	12-2OR4	12-2SN4
<b>28 DEGREE X 6 INCH</b> (FOR USE WITH BEADED OR HOOK CHAIN)	12-216	12-226	12-236	12-246	12-2OR6	12-2SN6
<b>45 DEGREE X 4 INCH</b> (FOR USE WITH BEADED OR HOOK CHAIN)	12-314	12-324	12-334	12-344	12-3OR4	12-3SN4
<b>45 DEGREE X 6 INCH</b> (FOR USE WITH BEADED OR HOOK CHAIN)	12-316	12-326	12-336	12-346	12-3OR6	12-3SN6
<b>RIGHT HAND TANK LEVERS: IN “CLASSIC” STYLE:</b>						
<b>8” RIGHT HAND TANK LEVERS</b> (FOR USE WITH HOOK CHAIN)	12R-940	N/A	12R-942	N/A	N/A	N/A

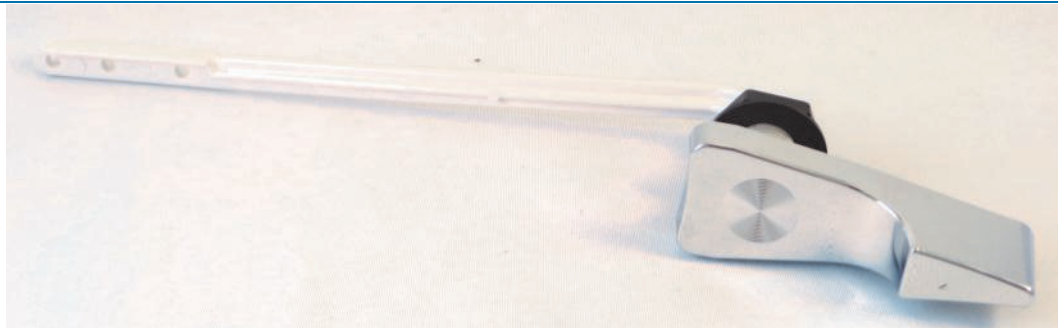





## ABS TANK LEVERS—ELKA “ELITE” HANDLE STYLE

- DURABLE PLASTIC TANK LEVER
- PRE-MOLDED TO SPECIFIC ANGLES AND LENGTHS
- COMPLETE WITH PLASTIC SPUD AND NUT
- REFER TO PAGE 5 FOR AVAILABLE TANK HANDLE FINISHES



SIZE	WHITE	COLOURS (PLEASE SPECIFY)	CHROME PLATED	PVD BRASS PLATED	O R B	SATIN NICKEL
<b>SINGLE SIZE TANK LEVERS:</b>						
<b>5 DEGREE X 4 INCH</b> (FOR USE WITH BEADED CHAIN)	EL-930	EL-931	EL-932	EL-928	EL-9OR4	EL-9SN4
<b>5 DEGREE X 6 INCH</b> (FOR USE WITH BEADED OR HOOK CHAIN)	EL-116	EL-126	EL-136	EL-146	EL-1OR6	EL-1SN6
<b>5 DEGREE X 8 INCH</b> (FOR USE WITH HOOK CHAIN ONLY)	EL-940	EL-941	EL-942	EL-938	EL-9OR8	EL-9SN8
<b>28 DEGREE X 4 INCH</b> (FOR USE WITH BEADED CHAIN ONLY)	EL-214	EL-224	EL-234	EL-244	EL-2OR4	EL-2SN4
<b>28 DEGREE X 6 INCH</b> (FOR USE WITH BEADED OR HOOK CHAIN)	EL-216	EL-226	EL-236	EL-246	EL-2OR6	EL-2SN6
<b>45 DEGREE X 4 INCH</b> (FOR USE WITH BEADED OR HOOK CHAIN)	EL-314	EL-324	EL-334	EL-344	EL-3OR4	EL-3SN4
<b>45 DEGREE X 6 INCH</b> (FOR USE WITH BEADED OR HOOK CHAIN)	EL-316	EL-326	EL-336	EL-346	EL-3OR6	EL-3SN6



## COMBINATION ARM TANK LEVERS

### METAL:

- BENDABLE METAL ARM FITS ALMOST ANY TOILET TANK INCLUDING FRONT MOUNT OR NEO-ANGLE
- SUITABLE FOR COMMERCIAL APPLICATIONS
- .080" THICK METAL ARMS
- COMES COMPLETE WITH CLIP TO ATTACH TO BEADED CHAIN
- PLASTIC SPUD AND NUT



### ABS PLASTIC:



- COMBINATION ABS PLASTIC TANK LEVERS: CUT TO FIT
- GROOVED FOR CUTTING TO DESIRED SIZE
- CONNECTS TO ANY HOOKED OR BEADED CHAIN OR STRAP FLAPPER

REFER TO PAGE 5 FOR AVAILABLE TANK HANDLE FINISHES

ELKA "CLASSIC" STYLE	WHITE	COLOURS (PLEASE SPECIFY)	CHROME PLATED	PVD BRASS PLATED	O R B	SATIN NICKEL
4" / 6" / 8" 5 DEGREE COMBINATION LEVERS	12-11C	12-12C	12-13C	12-14C	12-10RC	12-15NC
4" / 6" / 8" 28 DEGREE COMBINATION LEVERS	12-21C	12-22C	12-23C	12-24C	12-20RC	12-25NC
0.080" THICK METAL 8" LONG ARM LEVER	12-818	12-828	12-838	12-848	12-80R8	12-SN8
ELKA "ELITE" STYLE	WHITE	COLOURS (PLEASE SPECIFY)	CHROME PLATED	PVD BRASS PLATED	O R B	SATIN NICKEL
4" / 6" / 8" 5 DEGREE COMBINATION LEVERS	EL-11C	EL-12C	EL-13C	EL-14C	EL-10RC	EL-15NC
4" / 6" / 8" 28 DEGREE COMBINATION LEVERS	EL-21C	EL-22C	EL-23C	EL-24C	EL-20RC	EL-25NC
0.080" THICK METAL 8" LONG ARM LEVER	EL-818	EL-828	EL-838	EL-848	EL-80R8	EL-85NC



## 3-WAY UNIVERSAL TOILET LEVERS

**DURABLE ALL METAL COMPONENT LEVERS FIT 3 WAYS CAN BE USED AS:**

- FRONT MOUNT
- SIDE MOUNT
- ANGLE MOUNT
- TRIM FOR SHORTER APPLICATIONS

<b>PART #:</b>	<b>FINISH:</b>
14-303	CHROME
14-304	BRASS
14-305	SATIN NICKEL
14-306	OIL RUBBED BRONZE



## 4-WAY UNIVERSAL TOILET LEVERS

**DURABLE ALL METAL COMPONENT LEVERS FIT 4 WAYS. CAN BE USED AS:**

- 1) FRONT MOUNT
  - 2) SIDE MOUNT
  - 3) ANGLE MOUNT
  - 4) **RIGHT HAND MOUNT**
- TRIM FOR SHORTER APPLICATIONS

### TRADITIONAL STYLE HANDLE

<b>PART #:</b>	<b>FINISH:</b>
12-4WL-WH	WHITE
12-4WL-BO	BONE
12-4WL-CP	CHROME
12-4WL-SN	SATIN NICKEL
12-4WL-ORB	OIL RUBBED BRONZE
12-4WL-PB	POLISHED BRASS



### CONTEMPORARY STYLE HANDLE

<b>PART #:</b>	<b>FINISH:</b>
12-4WL-C-CP	CHROME
12-4WL-C-SN	SATIN NICKEL
12-4WL-C-ORB	OIL RUBBED BRONZE
12-4WL-C- PB	POLISHED BRASS





## SIDE MOUNT LEVER—UNIVERSAL FIT

AVAILABLE IN A CHOICE OF ARMS AND FINISHES, 10 INCH

PART #:	ARM:	FINISH:	PACKAGED:
12-871	BRASS	CHROME	INDIVIDUALLY BOXED
12-871BA	ALUMINUM	CHROME	BULK
12-871BB	BRASS	BONE	INDIVIDUALLY BOXED
12-871BW	BRASS	WHITE	INDIVIDUALLY BOXED



## SIDE MOUNT—PUSH BUTTON UNIVERSAL FIT

WELL SUITED TO AMERICAN STANDARD\* ELLISSE\*, PALLAS\* AND LEXINGTON\* TOILETS  
AVAILABLE IN CHOICE OF MATERIALS AND FINISHES, 8 INCH

PART #:	ARM:	FINISH:	PACKAGED:
12-328	ABS	PVD POLISHED BRASS	BULK
12-327 <sup>1</sup>	ABS	CHROME	BULK



PART #:	ARM:	FINISH:	PACKAGED:
12-868	BRASS	CHROME	INDIVIDUALLY BAGGED



## FRONT MOUNT PUSH BUTTON—UNIVERSAL FIT

AVAILABLE IN CHOICE OF COMPONENT MATERIALS

PART #:	SIZE:	ARM:	SPUD AND NUT:	PACKAGED:
12-867	8-1/4"	ROUND BRASS	ABS PLASTIC	BULK
12-877	5-1/2"	ROUND BRASS	ABS PLASTIC	BULK
12-1064PSB	8"	ROUND BRASS	ABS PLASTIC	BULK





## DURABLE GENERAL PURPOSE TANK LEVERS — UNIVERSAL FIT

### STANDARD METAL TANK LEVER

AVAILABLE IN CHOICE OF COMPONENT MATERIALS AND SIZES, CHROME PLATED

<u>PART #:</u>	<u>SIZE:</u>	<u>ARM:</u>	<u>SPUD AND NUT:</u>	<u>PACKAGED:</u>
12-864B	8"	BRASS	METAL	BULK
12-864PSB	8"	BRASS	PLASTIC	BULK



### DELUXE METAL TANK LEVER

AVAILABLE IN CHOICE OF COMPONENT MATERIALS AND SIZES, CHROME PLATED

<u>PART #:</u>	<u>SIZE:</u>	<u>ARM:</u>	<u>SPUD AND NUT:</u>	<u>PACKAGED:</u>
12-870B	8-1/4"	BRASS	METAL	BULK
12-870PSB	8-1/4"	BRASS	PLASTIC	BULK



### HEAVY DUTY METAL TANK LEVER

AVAILABLE IN CHOICE OF COMPONENT MATERIALS AND SIZES, CHROME PLATED

<u>PART #:</u>	<u>SIZE:</u>	<u>ARM:</u>	<u>SPUD AND NUT:</u>	<u>PACKAGED:</u>
12-865	8" STD	BRASS, FLAT	METAL	INDIVIDUALLY BOXED
12-865B	8" STD	BRASS, FLAT	METAL	BULK
12-866	10" OFFSET	BRASS FLAT	METAL	INDIVIDUALLY BOXED
12-866B	10" OFFSET	BRASS FLAT	METAL	BULK



<u>PART #:</u>	<u>SIZE:</u>	<u>ARM:</u>	<u>SPUD AND NUT:</u>	<u>PACKAGED:</u>
12-874	8" FANCY	BRASS FLAT	METAL	INDIVIDUALLY BOXED





## REPLACEMENT TANK LEVERS — FIT AMERICAN STANDARD\*

### DURABLE PLASTIC TANK LEVER

PRE-MOLDED TO SPECIFIC ANGLE FIT AMERICAN STANDARD\* TOILETS

#### 5 DEGREE X 6 INCH

FOR REF# 047148 - XXXXA

<u>PART #:</u>	<u>FINISH:</u>
12-004W	WHITE
12-004C	CHROME
12-004B	BONE

#### 15 DEGREE X 6 INCH

FOR REF# 4063.XXX

<u>PART #:</u>	<u>FINISH:</u>
12-005W	WHITE
12-005C	CHROME
12-005B	BONE

#### 30 DEGREE X 6 INCH

FOR REF# 047192 - XXXXA:

4003, 4010, 4037, 4061, 4096, 4110, 4112, 4114,  
4310, 4314, 4392, 4396 AND 4707 TANKS

<u>PART #:</u>	<u>FINISH:</u>
12-009W	WHITE
12-009C	CHROME
12-009B	BONE

#### 45 DEGREE X 4 INCH

<u>PART #:</u>	<u>FINISH:</u>
12-314W	WHITE
12-314C	CHROME
12-314B	BONE

#### 45 DEGREE X 6 INCH

FOR REF# 047242 - XXXXA:

4029 AND 4072 TANKS

AND

2099 AND 2100 ONE PIECE TOILETS

<u>PART #:</u>	<u>FINISH:</u>
12-047W	WHITE
12-047C	CHROME
12-047B	BONE

**PACKAGED:** HANGING SEALED POLY BAGS

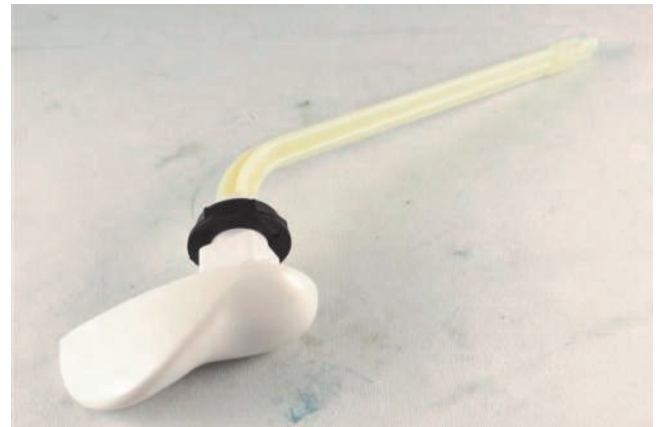



## TOILET TANK LEVER REPLACES AMERICAN STANDARD\*

AMERICAN STANDARD\* CADET III\* REPLACEMENT TRIP LEVER, REF# 738473-0020A FOR CADET III\* SERIES TOILET MODELS #2386, 2383 AND 2384, PLASTIC ARM, CHROME PLATED

**Part #:** 12-903  
**Packaged:** INDIVIDUALLY BAGGED  
**Carton Qty:** 200  
**Replaces:**  
**AMERICAN STANDARD\* CADET III\***



## TOILET LEVER REPLACEMENT FITS AMERICAN STANDARD\*

AMERICAN STANDARD\* REPLACEMENT TRIP LEVER, REF# 738153-0020A, CHROME PLATED

**Part #:** 12-153  
**Packaged:** INDIVIDUALLY BAGGED  
**Carton Qty:** 200  
**Replaces:**  
**AMERICAN STANDARD\***

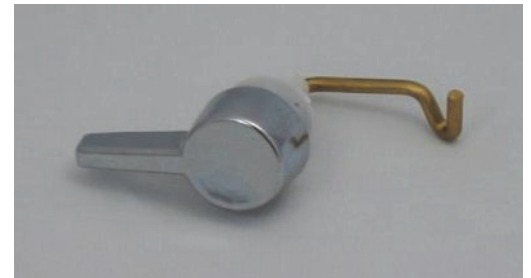

## TOILET LEVER REPLACES AMERICAN STANDARD\*

AMERICAN STANDARD\* REPLACEMENT TRIP LEVER WITH LINKAGE, REF# 738254-0020A, CHROME PLATED

**Part #:** 12-254  
**Packaged:** INDIVIDUALLY BAGGED  
**Carton Qty:** 200  
**Replaces:**  
**AMERICAN STANDARD\***



## TOILET LEVER REPLACES AMERICAN STANDARD\*

AMERICAN STANDARD\* REPLACEMENT TRIP LEVER, REF# 738772-0020A, CHROME PLATED

**Part #:** 12-772  
**Packaged:** INDIVIDUALLY BAGGED  
**Carton Qty:** 200  
**Replaces:**  
**AMERICAN STANDARD\***





## TOILET LEVER FITS AMERICAN STANDARD\*

AMERICAN STANDARD\* REPLACEMENT TRIP LEVER, REF# 738473-0020A FOR CHAMPION\* TOILETS, METAL ARM, CHROME PLATED

**Part #:** 12-473  
**Packaged:** INDIVIDUALLY BAGGED  
**Carton Qty:** 200  
**Replaces:**  
**AMERICAN STANDARD\***



## TOILET LEVER REPLACES AMERICAN STANDARD\*

REPLACEMENT LEVER FITS AMERICAN STANDARD\* 4-1/4" BRASS LEVER ARM, ABS PLASTIC SPUD AND NUT, CHROME PLATED COMPLETE WITH METAL CLIP

**Part #:** 12-872B  
**Packaged:** INDIVIDUALLY BAGGED  
**Carton Qty:** 200  
**Replaces:** AMERICAN STANDARD\*

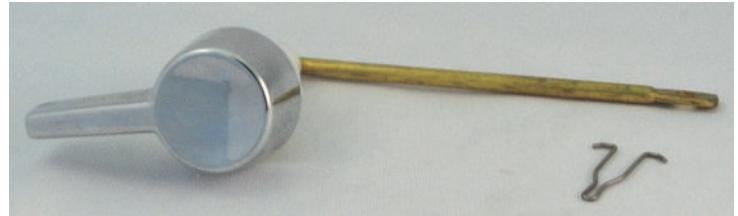

## TOILET LEVER REPLACES AMERICAN STANDARD\*

REPLACEMENT LEVER FITS AMERICAN STANDARD\* 6-1/8" BRASS LEVER ARM, ABS PLASTIC SPUD AND NUT, CHROME PLATED COMPLETE WITH METAL CLIP

**Part #:** 12-873B  
**Packaged:** INDIVIDUALLY BAGGED  
**Carton Qty:** 200  
**Replaces:**  
**AMERICAN STANDARD\***



## TOILET LEVER REPLACES ELJER\*

REPLACEMENT LEVER FITS ELJER\* SIDE MOUNT TANK LEVER, REF# 495-2704, BRASS LEVER ARM, ABS PLASTIC SPUD AND NUT - CHROME PLATED

<b>Part #:</b>	<b>Packaged:</b>	<b>Finish:</b>
12-860	INDIVIDUALLY BOXED	CHROME
12-860B	BULK POLY BAG	CHROME
12-861	INDIVIDUALLY BOXED	BRASS

**Carton Qty:** 50  
**Replaces:**  
**ELJER\***

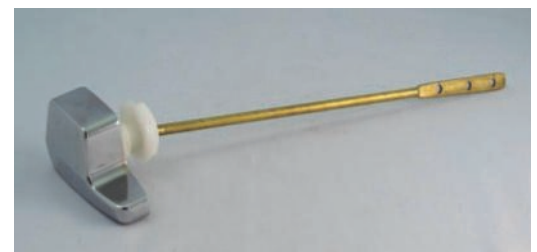





## TOILET LEVER FITS GERBER\*

GERBER\* PRESSURE ASSIST TRIP LEVER WITH LINKAGE, REF# 99-571-KT, METAL ARM, CHROME PLATED HANDLE

**Part #:** 12-571  
**Packaged:** INDIVIDUALLY BAGGED  
**Carton Qty:** 200  
**Replaces:** GERBER\*



## TOILET LEVER REPLACES KOHLER\*

REPLACEMENT LEVER FITS KOHLER\* WELLWORTH II\* SERIES, REF# K9404, TANK LEVER, ABS PLASTIC LEVER ARM, SPUD AND NUT - CHROME PLATED

<b>Part #:</b>	<b>Packaged:</b>	<b>Finish:</b>
12-862	INDIVIDUALLY BOXED	CHROME
12-862B	BULK POLY BAG	CHROME
12-863	INDIVIDUALLY BOXED	BRASS

**Carton Qty:** 50  
**Replaces:** KOHLER\*



## TOILET LEVER FITS KOHLER\*

REF# 81609 TANK LEVER CHROME (BOX)

**Part #:** 12-875  
**Packaged:** INDIVIDUALLY BAGGED  
**Carton Qty:** 100  
**Replaces:** KOHLER\*



## TOILET LEVER FITS KOHLER\*

KOHLER\* STYLE LEVER

**Part #:** 12-876  
**Packaged:** INDIVIDUALLY BAGGED  
**Carton Qty:** 100  
**Replaces:** KOHLER\*





## TOILET LEVER REPLACES MANSFIELD\*

MANSFIELD\* STYLE REPLACEMENT TANK LEVER REF# 42 WITH 10-1/4" ROUND BRASS ARM, ABS PLASTIC SPUD AND NUT, CHROME PLATED HANDLE

**Part #:** 12-420  
**Packaged:** INDIVIDUALLY BAGGED  
**Carton Qty:** 100  
**Replaces:** MANSFIELD\*



## TOILET LEVER REPLACES MANSFIELD\*

MANSFIELD\* STYLE REPLACEMENT TANK LEVER WITH 9" ABS PLASTIC ARM, SPUD AND NUT, CHROME PLATED HANDLE

**Part #:** 12-869B  
**Packaged:** INDIVIDUALLY BAGGED  
**Carton Qty:** 200  
**Replaces:** MANSFIELD\*

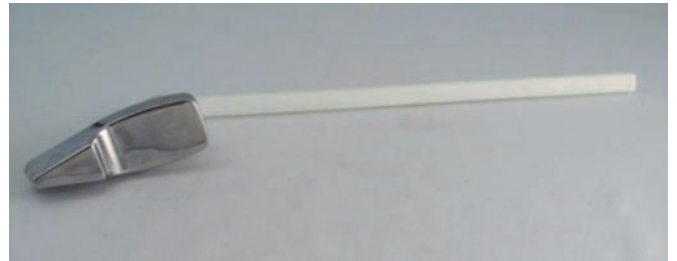

## TOILET LEVER REPLACES UNIVERSAL RUNDLE\*

UNIVERSAL RUNDLE\* STYLE REPLACEMENT TANK LEVER WITH 8" FLAT BRASS ARM WITH TWIST AND NOTCH, ABS PLASTIC SPUD AND NUT, CHROME PLATED HANDLE

**Part #:** 12-311  
**Packaged:** INDIVIDUALLY BAGGED  
**Carton Qty:** 100  
**Replaces:** UNIVERSAL RUNDLE\*

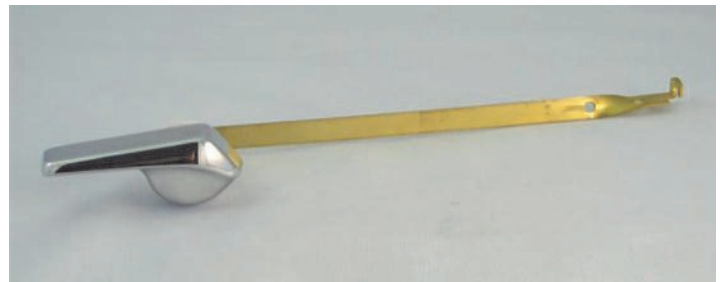



## DURABLE METAL REPLACEMENT TANK LEVERS FIT TOTO\*

AVAILABLE IN A CHOICE OF MODELS AND FINISHES; ALL INDIVIDUALLY BAGGED

<b>MODEL #:</b>	<b>FINISH:</b>	<b>FITS:</b>
PLU004#ORB	OIL RUBBED BRONZE	THU004*
PLU004#CP	CHROME PLATED	THU004*
PLU004#SN	SATIN NICKEL	THU004*

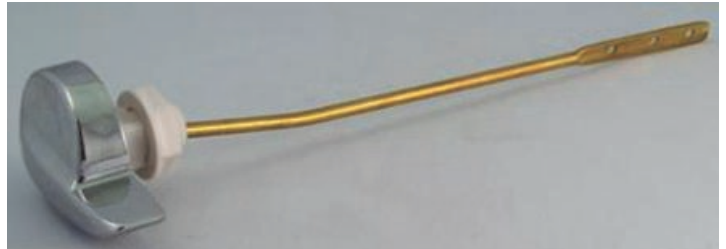

<b>MODEL #:</b>	<b>FINISH:</b>	<b>FITS:</b>
PLU061#ORB	OIL RUBBED BRONZE	THU061*
PLU061#CP	CHROME PLATED	THU061*
PLU061#SN	SATIN NICKEL	THU061*



<b>MODEL #:</b>	<b>FINISH:</b>	<b>FITS:</b>
PLU068#ORB	OIL RUBBED BRONZE	THU068*
PLU068#CP	CHROME PLATED	THU068*
PLU068#SN	SATIN NICKEL	THU068*



<b>MODEL #:</b>	<b>FINISH:</b>	<b>FITS:</b>
PLU146#CP	CHROME PLATED	THU146*
PLU146#SN	SATIN NICKEL	THU146*





## REGULAR FLAPPER

ELKA RUBBER FLAPPER COMPLETE WITH 8" STAINLESS STEEL CHAIN AND HOOK

**Part #:** 12-805  
**Packaged:** INDIVIDUALLY BAGGED  
**Carton Qty:** 200



## 3-WAY FLAPPER

ELKA 3-WAY RUBBER FLAPPER COMPLETE WITH 8" STAINLESS STEEL CHAIN AND HOOK

**Part #:** 12-806  
**Packaged:** INDIVIDUALLY BAGGED  
**Carton Qty:** 200

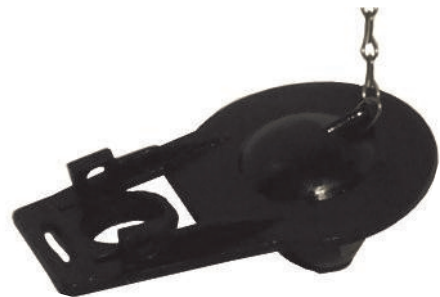

## REGULAR VINYL FLAPPER

ELKA VINYL CHEMICAL RESISTANT FLAPPER COMPLETE WITH 9" STAINLESS STEEL CHAIN AND HOOK

**Part #:** 12-810  
**Packaged:** INDIVIDUALLY BAGGED  
**Carton Qty:** 100



## ADJUSTABLE FLOW FLAPPER

ELKA VINYL CHEMICAL RESISTANT ADJUSTABLE FLOW FLAPPER COMPLETE WITH 4 INSERTS TO ADJUST FLOW AND 8" STAINLESS STEEL CHAIN AND HOOK

**Part #:** 12-811  
**Packaged:** INDIVIDUALLY BAGGED  
**Carton Qty:** 100





## VINYL FLAPPER 2" BLUE

REGULAR VINYL CHEMICAL RESISTANT FLAPPER, COMPLETE WITH STAINLESS STEEL CHAIN AND HOOK, BLUE

**Part #:** 12-812  
**Packaged:** INDIVIDUALLY BAGGED  
**Carton Qty:** 100  
**Replaces:**  
**AMERICAN STANDARD\***



## FLAPPER REPLACES CRANE\*

REGULAR RUBBER FLAPPER REPLACES CRANE\* STYLE #57, COMPLETE WITH STYROFOAM FLOAT AND 8" STAINLESS STEEL CHAIN AND HOOK

**Part #:** 12-807  
**Packaged:** INDIVIDUALLY BAGGED  
**Carton Qty:** 200  
**Replaces:** CRANE\*



## VINYL MOLDED STRAP FLAPPER

REGULAR VINYL FLAPPER CHEMICAL RESISTANT

**Part #:** 12-808  
**Packaged:** INDIVIDUALLY BAGGED  
**Carton Qty:** 200



## FLAPPER REPLACES KOHLER\*

REGULAR RUBBER FLAPPER REPLACES KOHLER\*, COMPLETE WITH 8" STAINLESS STEEL CHAIN AND HOOK

**Part #:** 12-809  
**Packaged:** INDIVIDUALLY BAGGED  
**Carton Qty:** 200  
**Replaces:** KOHLER\*





## REPLACEMENT FOR TOTO\*

REPLACEMENT FOR TOTO\* THU 140S BLUE FLAPPER

**Part #:** 12-140  
**Packaged:** INDIVIDUALLY BOXED  
**Carton Qty:** 40  
**Replaces:**  
**TOTO\***



## REPLACEMENT FOR TOTO\*

REPLACEMENT FOR TOTO\* THU 175S RED FLAPPER

**Part #:** 12-175  
**Packaged:** INDIVIDUALLY BOXED  
**Carton Qty:** 40  
**Replaces:**  
**TOTO\***





## WATER CONTROL VALVES—8 AND 10 INCH HEIGHTS

REPLACEMENT WATER CONTROL VALVE FITS ALL STANDARD TOILETS INCLUDING DOUGLAS\* HOOV-R-LINE\*, ANTI-SIPHON, SNAP ACTION SHUT OFF, EFFICIENT OPERATION AT ANY WATER PRESSURE, COMPLETE WITH COUPLING AND FLANGE NUTS AND 7" REFILL TUBE

Part #:	Size:	Packaged:
12-823	8" TALL	INDIVIDUALLY BAGGED
12-923	10" TALL	INDIVIDUALLY BAGGED

Carton Qty: 50

Replaces:  
**DOUGLAS\***



## FLUSH VALVE REPLACES DOUGLAS\*

REPLACEMENT FLUSH VALVE FITS ALL STANDARD TOILETS INCLUDING DOUGLAS\* HOOV-R-LINE\*, 8-11/16" TALL, 9" STAINLESS STEEL CHAIN, VINYL FLAPPER

Part #:	12-922
Packaged:	INDIVIDUALLY BAGGED
Carton Qty:	48
Replaces:	<b>DOUGLAS*</b>



## FILL VALVE CAP

FILL VALVE CAP ONLY FOR 12-823/12-923

Part #:	12-999
Packaged:	INDIVIDUALLY BAGGED
Carton Qty:	200





## REPAIR KIT FOR IBI-X FILL VALVE

REPAIR KIT FITS FOUNDRY\* IBI-X FILL VALVE

**Part #:** 12-IBIX-RK  
**Packaged:** INDIVIDUALLY BAGGED  
**Carton Qty:** 200  
**Replaces:**  
**FOUNDRY\***



## IBIX FILL VALVE

IBIX FILL VALVE

**Part #:** 12-IBIX  
**Packaged:** INDIVIDUALLY BAGGED  
**Carton Qty:** 40



## AMERICAN STANDARD\*

AMERICAN STANDARD\* #5 ACTUATING UNIT - CLOSED ENDS

**Part #:** 12-036  
**Packaged:** INDIVIDUALLY BAGGED  
**Carton Qty:** 50  
**Replaces:**  
**AMERICAN STANDARD\* MODELS AF-4055, F-4070**



## TILT VALVE ASSEMBLY

AMERICAN STANDARD\* #5 VALVE ASSEMBLY REPLACEMENT BLACK - ONE END CAPPED, ONE OPEN

**Part #:** 12-936  
**Packaged:** INDIVIDUALLY BAGGED  
**Carton Qty:** 50  
**Replaces:**  
**AMERICAN STANDARD\* FITS MODELS AF-4055, F-4070:**







**ABS PLASTIC FLUSH VALVE AND COMPONENTS FITS AMERICAN STANDARD\***

**REPLACEMENT KIT AND COMPONENTS FIT AMERICAN STANDARD\* FLUSH VALVE (CLOSED BOTH SIDES) AVAILABLE COMPLETE AND IN COMPONENT PIECES**

<b>MODEL #:</b>	<b>ITEM :</b>	<b>PACKAGED:</b>
12-927	COMPLETE TILT VALVE KIT	INDIVIDUALLY BOXED



12-927A  
 12-927C  
 12-927D  
 12-927W

REPLACEMENT TILT VALVE ONLY  
 REPLACEMENT BEADED CHAIN  
 REPLACEMENT SNAP ON DISK  
 REPLACEMENT TANK TO BOWL GASKET

INDIVIDUALLY BAGGED  
 INDIVIDUALLY BAGGED  
 INDIVIDUALLY BAGGED  
 INDIVIDUALLY BAGGED



## PLASTIC BOLT CAPS

- DURABLE PLASTIC SNAP FIT BOLT CAPS AND WASHERS AVAILABLE IN A VARIETY OF COLOURS
- ALL WASHERS ARE MANUFACTURED IN “NATURAL” COLOUR ONLY
- AVAILABLE IN:
  - BULK WITH WASHERS PACKAGED SEPARATELY, OR
  - PRE-PACKAGED IN POLYBAGS (2 BOLT-CAPS AND 2 WASHERS PER PACK)
- PRE-PRINTED POLYBAGS AVAILABLE - PLEASE CALL FOR A QUOTE



<b>PART #:</b>	<b>FINISH:</b>	<b>PACKAGING</b>
12-933	WHITE	POLYBAG
12-933 BO	BONE	POLYBAG
12-933B	WHITE CAPS ONLY	BULK
12-933W	NATURAL WASHERS ONLY	BULK
12-934	WHITE	BULK
12-934 (COL)	SPECIFY COLOUR	BULK
12-935	WHITE SMALL CAPS	BULK
12-935 BO	BONE SMALL CAPS	BULK





## TANK TO BOWL SET, CLOSET BOLTS AND CLOSET SCREW SETS

- DURABLE SOLID BRASS OR BRASS PLATED METAL COMPONENTS AVAILABLE IN A SELECTION OF SIZES
- ALL SETS ARE PREPACKAGED IN POLY BAGS AS INDICATED BELOW
- PRE-PRINTED POLYBAGS AVAILABLE - PLEASE CALL FOR A QUOTE

PART#	DESCRIPTION:	MATERIAL:	SIZE:	SET INCLUDES:
12-600P	CLOSET BOLT	BRASS PLATED	5/16" x 2-1/4"	2 EACH: BOLTS, METAL WASHERS, NUTS
12-600B	CLOSET BOLT	SOLID BRASS	5/16" x 2-1/4"	2 EACH: BOLTS, METAL WASHERS, NUTS
12-610B	CLOSET BOLT	SOLID BRASS	5/16" x 3-1/2"	2 EACH: BOLTS, METAL WASHERS, NUTS
12-620P	TANK TO BOWL SET	BRASS PLATED	5/16" x 3"	2 BOLTS, 4 METAL WASHERS, 4 RUBBER WASHERS, 2 HEX NUTS AND 2 WING NUTS
12-625B	TANK TO BOWL SET	SOLID BRASS	5/16" x 3"	2 BOLTS, 4 METAL WASHERS, 4 RUBBER WASHERS AND 4 HEX NUTS
12-630P	CLOSET SCREW SET	BRASS PLATED	1/4" x 2-1/4"	2 EACH: BOLTS, METAL WASHERS AND ACORN NUTS
12-630B	CLOSET SCREW SET	SOLID BRASS	1/4" x 2-1/4"	2 EACH: BOLTS, METAL WASHERS AND ACORN NUTS
12-631P	CLOSET SCREW SET	BRASS PLATED	5/16" x 2-1/2"	2 EACH: BOLTS, METAL WASHERS AND ACORN NUTS
12-631B	CLOSET SCREW SET	SOLID BRASS	5/16" x 2-1/2"	2 EACH: BOLTS, METAL WASHERS AND ACORN NUTS





## TOILET SEAT BOLTS

DURABLE ABS PLASTIC TOILET SEAT BOLTS COMPLETE WITH NUT AND WASHER

<b>Part #:</b>	<b>Size:</b>	<b>Packaging:</b>
<b>12-628</b>	7/16"	INDIVIDUALLY BAGGED
<b>12-629</b>	5/16"	INDIVIDUALLY BAGGED

Carton Qty: 1000



## TOILET SEAT HINGES

ELKA TOILET SEAT HINGES ONE PAIR (2) FOR WOOD TOILET SEAT - WHITE

**Part #:** 12-920  
**Packaged:** INDIVIDUALLY BAGGED  
**Carton Qty:** 250



## TOILET TISSUE ROLLER

INSERT FOR STANDARD TOILET TISSUE ROLLER, SPRING LOADED, WHITE PLASTIC

**Part #:** 12-924  
**Packaged:** INDIVIDUALLY BAGGED  
**Carton Qty:** 500

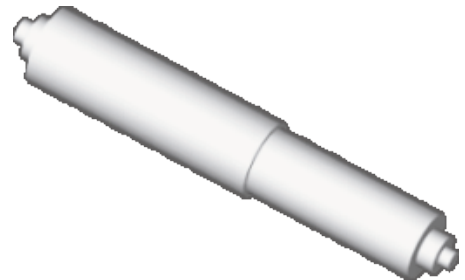



## FAUCET SHANK EXTENSIONS

DURABLE RESIN PLASTIC EXTENSIONS COMPLETE WITH NUTS AND SPACERS, PROVIDE UP TO 2 INCHES IN EXTRA LENGTH FOR FAUCET INSTALLATIONS.

<b>Part #:</b>	<b>Packaging:</b>
<b>13-000</b>	<b>BAGGED IN PAIRS</b>

Carton Qty: 100



## TUB/SHOWER CARTRIDGE REPLACES DELTA\*

REPLACEMENT TUB AND SHOWER CARTRIDGE FITS DELTA\* MONITOR\*, Ref RP#19804\*

<b>Part #:</b>	<b>Packaging:</b>
<b>13-557</b>	<b>BAGGED</b>

Carton Qty: 100



## TUB/SHOWER CARTRIDGE REPLACES DELTA\*

REPLACEMENT TUB AND SHOWER CARTRIDGE FITS DELTA\* MONITOR\*, Ref RP#46074\*

<b>Part #:</b>	<b>Packaging:</b>
<b>13L-557</b>	<b>BAGGED</b>

Carton Qty: 100





## UNDER-COUNTER REPAIR PLATES

**RIGID DURABLE PLASTIC, TRIM TO FIT ALL UNDER COUNTER APPLICATIONS**

- Lightweight but sturdy
- Easy to tack to underside of any counter
- Rounded corners for installation safety
- Holes set for 8" and 4" centres, with additional versions with slots for more complicated under counter applications
- Easy to cut to size or for odd shaped applications

An economical and effective solution for under counter reinforcement for any faucet installations.

<b>Part #:</b>	<b>SIZE:</b>	<b>CONFIGURATION:</b>
<b>13-801</b>	<b>8"</b>	<b>3 Holes</b>
<b>18-802</b>	<b>8"</b>	<b>3 Open Slots</b>
<b>13-803</b>	<b>4"</b>	<b>2 Holes</b>
<b>13-804</b>	<b>4"</b>	<b>2 Open Slots</b>





# REPAIR PARTS—BULK



# **ELKA**

## **INDUSTRIES, INC.**

**ELKA INDUSTRIES INC.  
901 DILLINGHAM ROAD, PICKERING, ONTARIO CANADA  
TEL: 1-905-839-8888**

**EMAIL: [SALES@ELKAINDUSTRIES.COM](mailto:SALES@ELKAINDUSTRIES.COM)  
[WWW.ELKAINDUSTRIES.COM](http://WWW.ELKAINDUSTRIES.COM)**